

ASSEMBLY INSTRUCTION

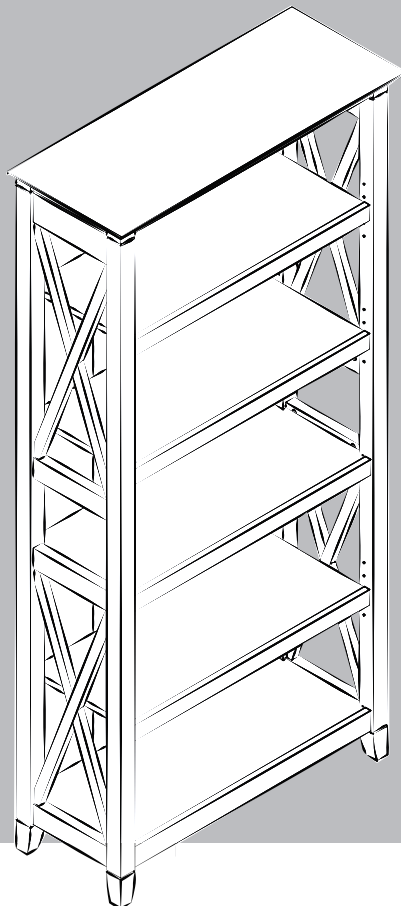

Bookcase

Maximum weight capacity: 25lbs (11.3 kg) equally distributed per bottom shelf and adjustable shelf.
Record date of purchase below and save this booklet for future reference.



THIS PRODUCT SHOULD BE ANCHORED TO A WALL OR OTHER SUITABLE SURFACE TO AVOID SERIOUS INJURY.

To help avoid any serious or fatal injury, an Anti-Tip kit has been included with this product to prevent toppling. We strongly recommend that this product be permanently fixed to the wall or other suitable surface.

The Anti-Tip kit included with this product is only suitable for **dry wall (Plaster board)**. A different anchor fitting will need to be purchased separately at your local hardware store if the product is to be anchored to a brick/concrete wall.

Please seek professional advice if you are in doubt what fixing device to use.

Item KWB132WG / KWB132BC

MODEL KWB132WG

A [1] W182249	G [3] W181039
B [1] W181034	H [1] W181040
C [2] S182250	I [2] W182251
D [3] W181036	
E [1] W181037	
F [1] W181038	

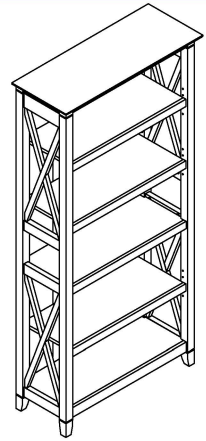
**MODEL KWB132BC**

A [1] W182988	G [3] W182995
B [1] W182989	H [1] W182994
C [2] S182990	I [2] W182992
D [3] W182991	
E [1] W182996	
F [1] W182993	

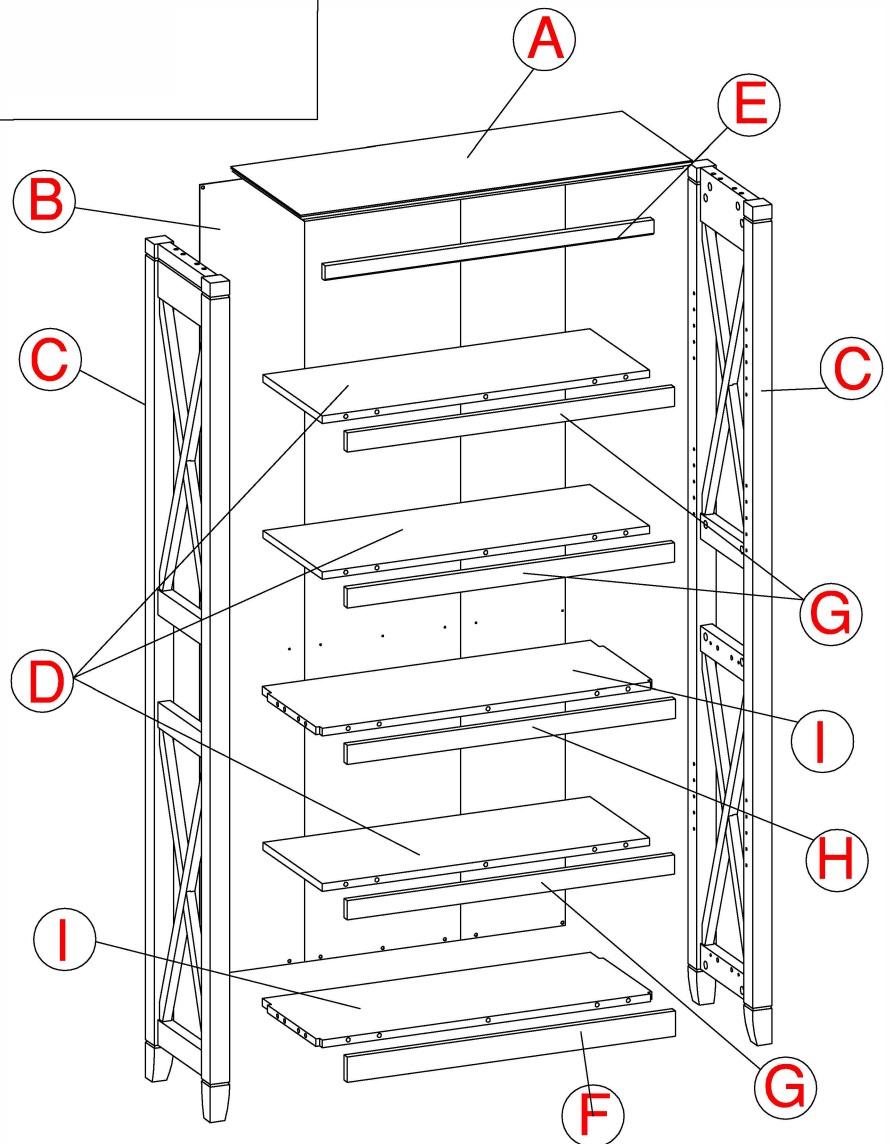

Fasteners are shown in actual size.

Los fijadores son demostrados en su tamaño actual.

Les attaches sont montrées dans l'échelle grandeur.

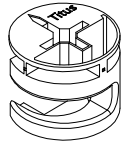
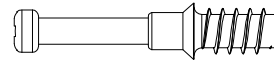
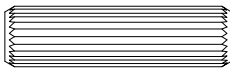
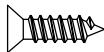
H181468**KD Cam****Quantity**
27**H180604****KD Bolt****Quantity**
27**H38169****Wood Dowel**
8 x 30mm**Quantity**
16**H34174****#3x 3/4"****Quantity**
44**H124395****#6 x 1/2"****Quantity**
6

H23604

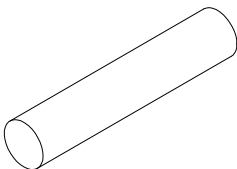

Shelf Pin

Quantity
12

H137197

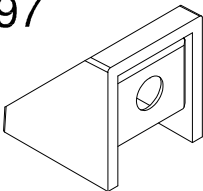

Plastic Bracket

Quantity
3

MODEL KWB132WG

H180730

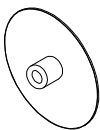

Cover Cap

Quantity
12

MODEL KWB132BC

H159346

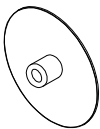

Cover Cap

Quantity
12

Q181420

H181434

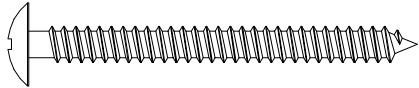
Quantity
1

#10x2"

H145191

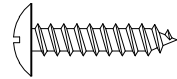
Quantity
1

#8 x 3/4"

H181419

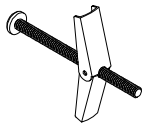
Quantity
1

Toggle Bolt

H181412

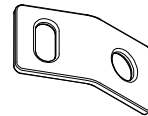
Quantity
2

Connecting Plate

H181411

Quantity
1

Nylon Cable Tie

Common assembly techniques.
Técnica común de ensamblaje.
Techniques communes d'assemblage.

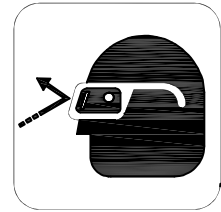
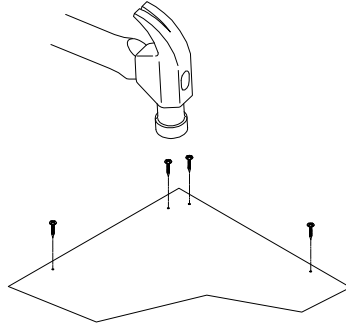
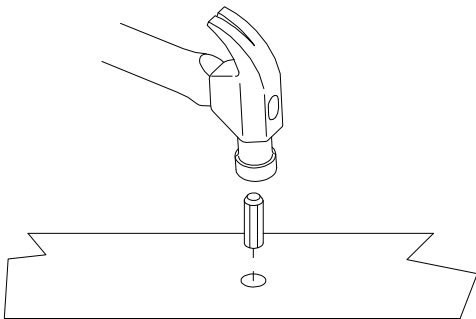

Push the KD cam all the way into the hole before tightening.
Empujar la leva KD hasta el final en el agujero antes de apretar.
Pousser la came de KD tout le chemin dans le trou avant de serrer.

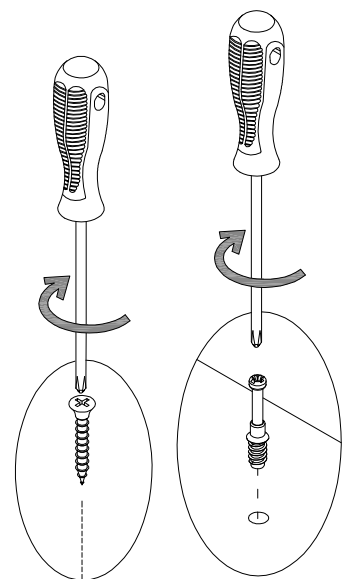
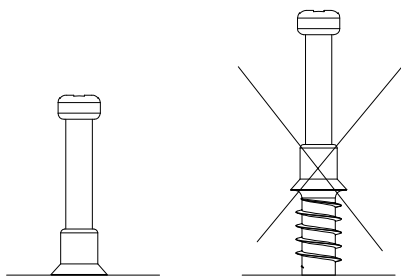
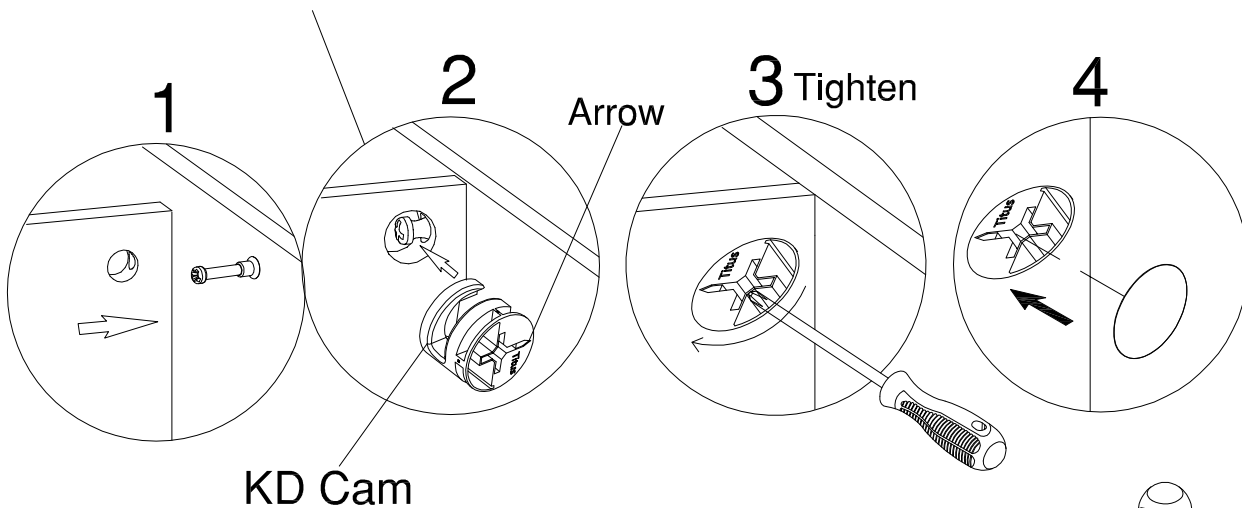

H38169

Wood Dowel
8 x 30mm

[2]

H180604

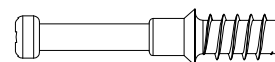

KD Bolt

[8]

MODEL KWB132WG

H180730

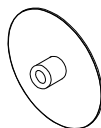

[8]

Cover Cap

MODEL KWB132BC

H159346



[8]

Cover Cap

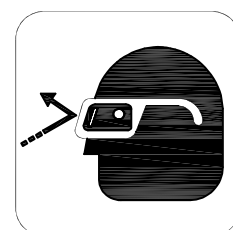
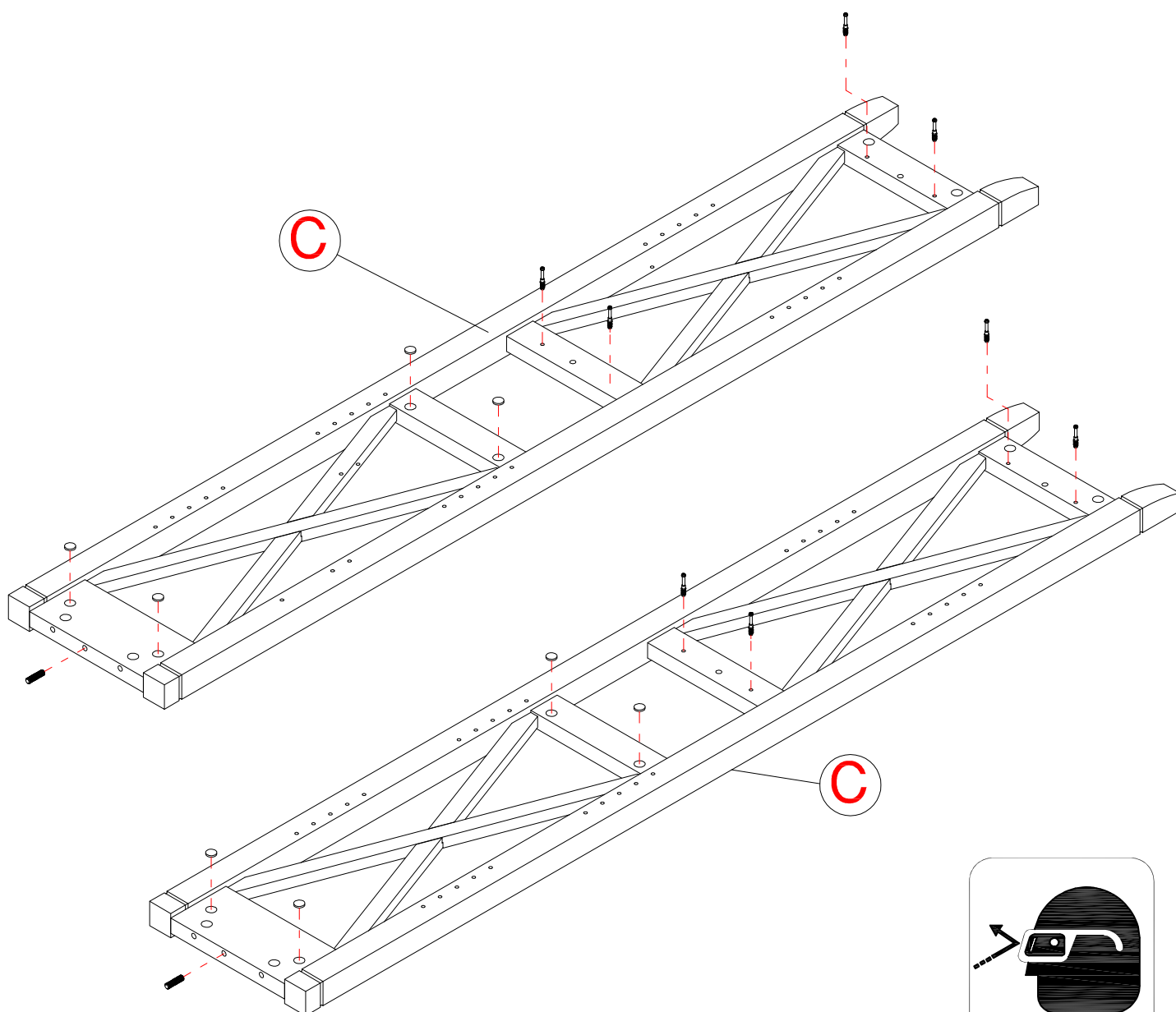

H38169

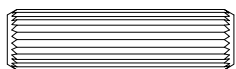

Wood Dowel
8 x 30mm

[8]

H180604

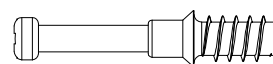

KD Bolt

[3]

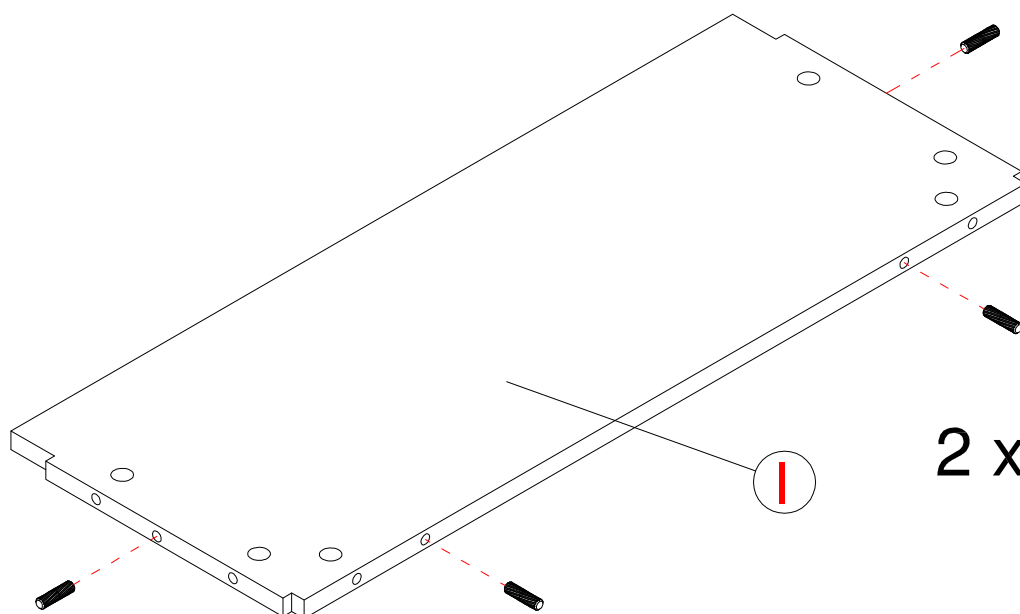
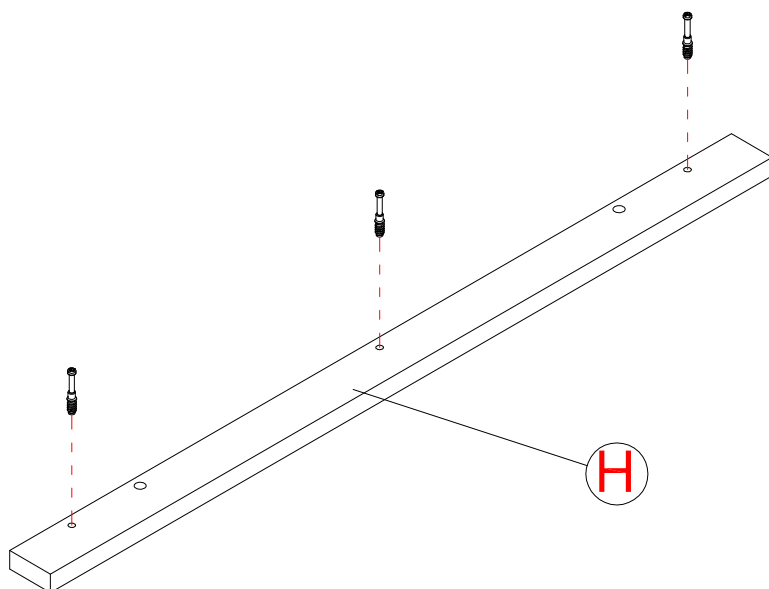
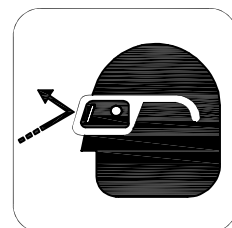

H181468

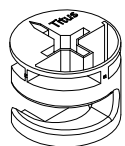

KD Cam

[3]

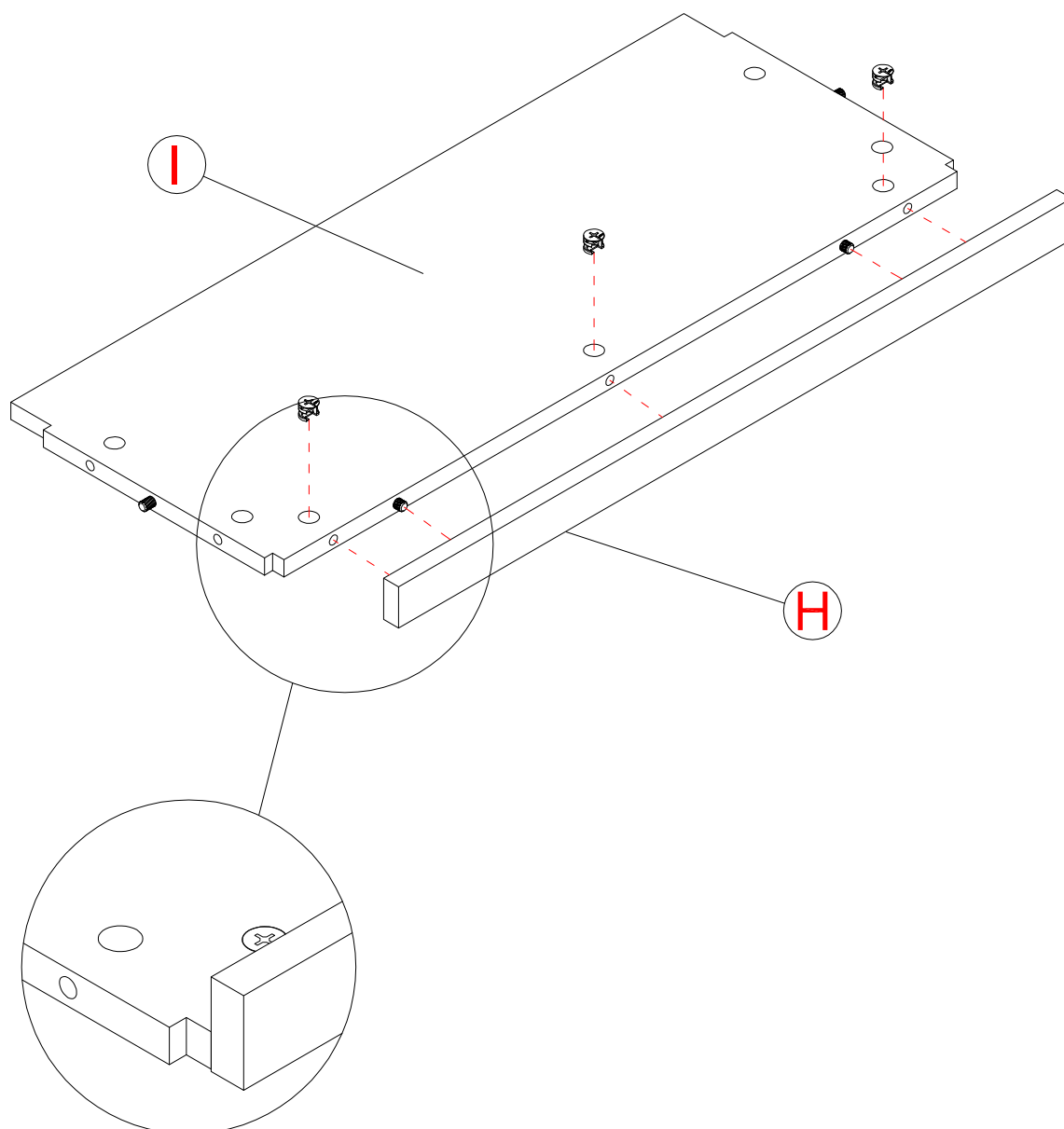

H181468

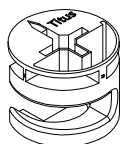

KD Cam

[3]

H180604

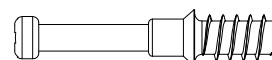

KD Bolt

[3]

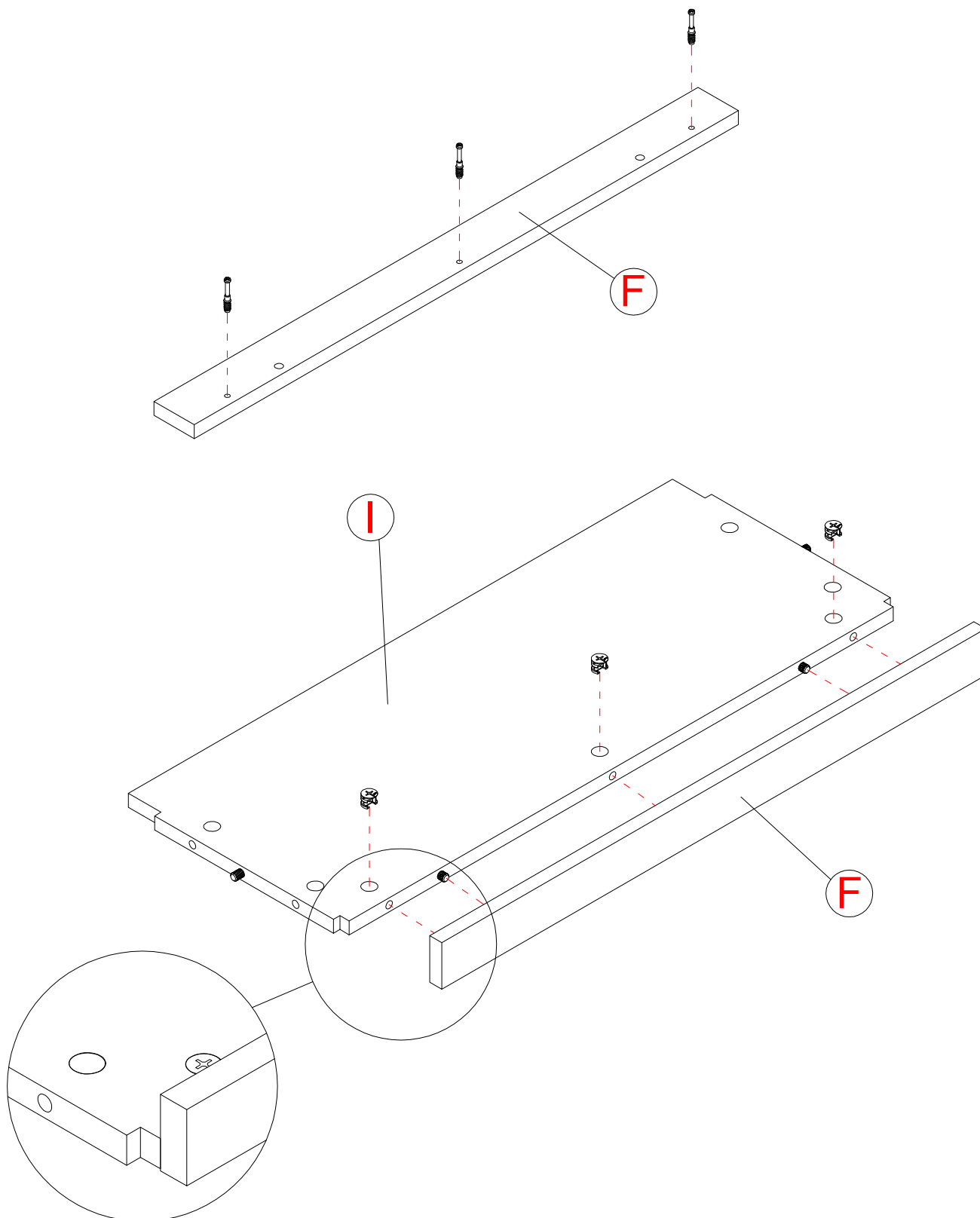

H181468

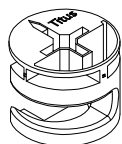

KD Cam

[4]

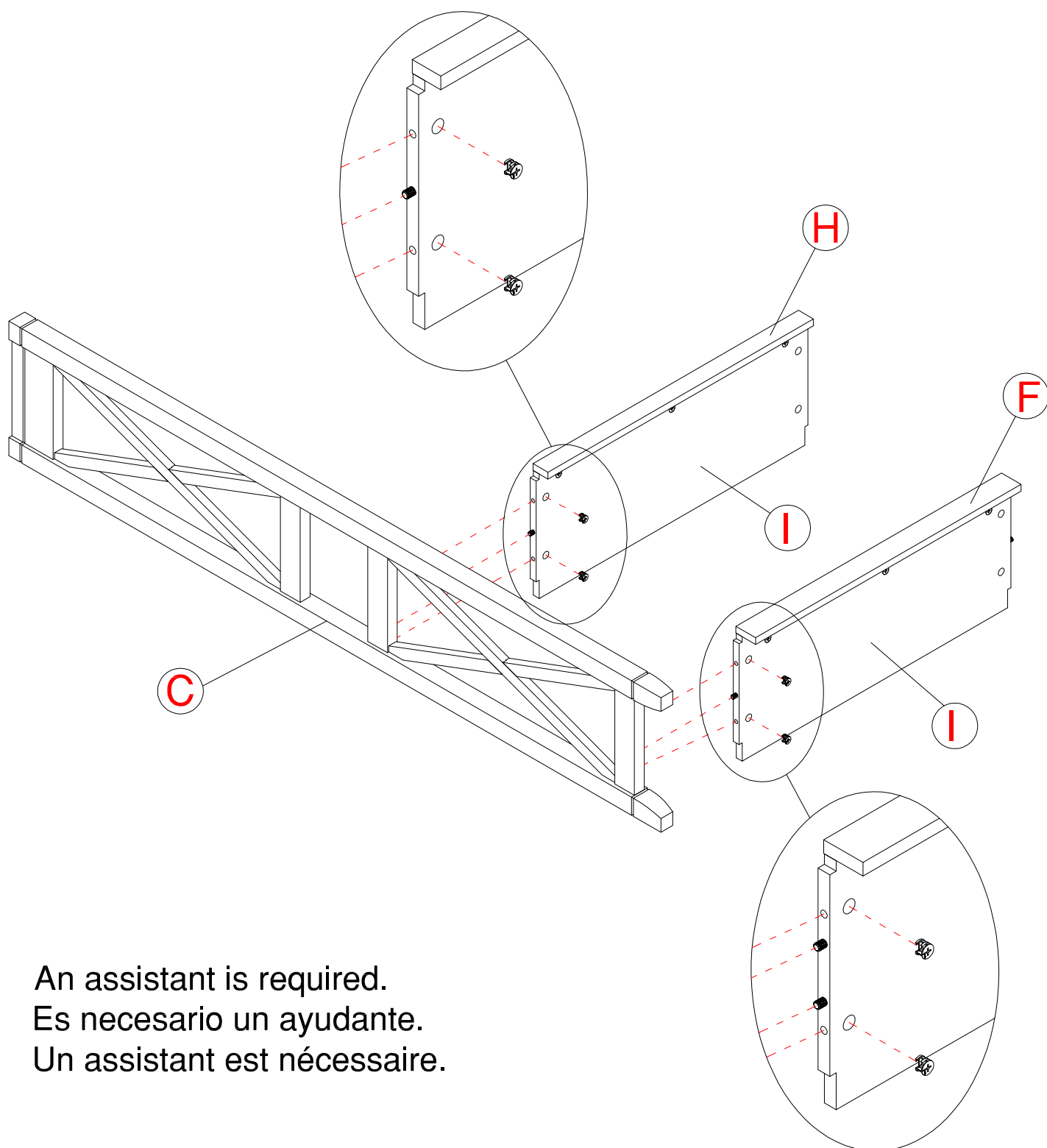

An assistant is required.
Es necesario un ayudante.
Un assistant est nécessaire.

H181468

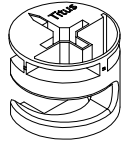

KD Cam

[4]

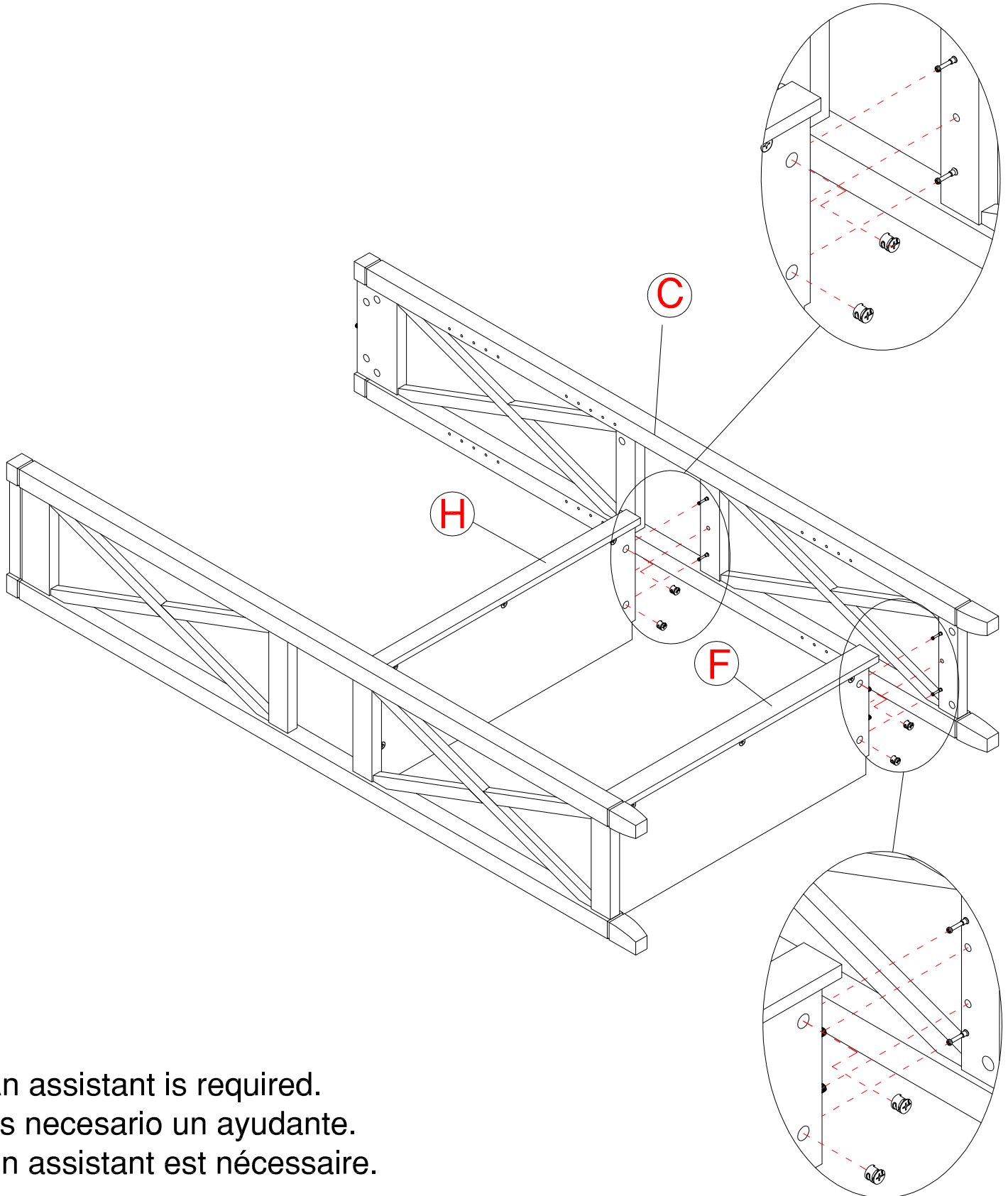

An assistant is required.
Es necesario un ayudante.
Un assistant est nécessaire.

H124395

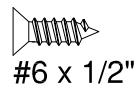

[3]

H137197



[3]

Plastic Bracket

H180604



KD Bolt

[4]

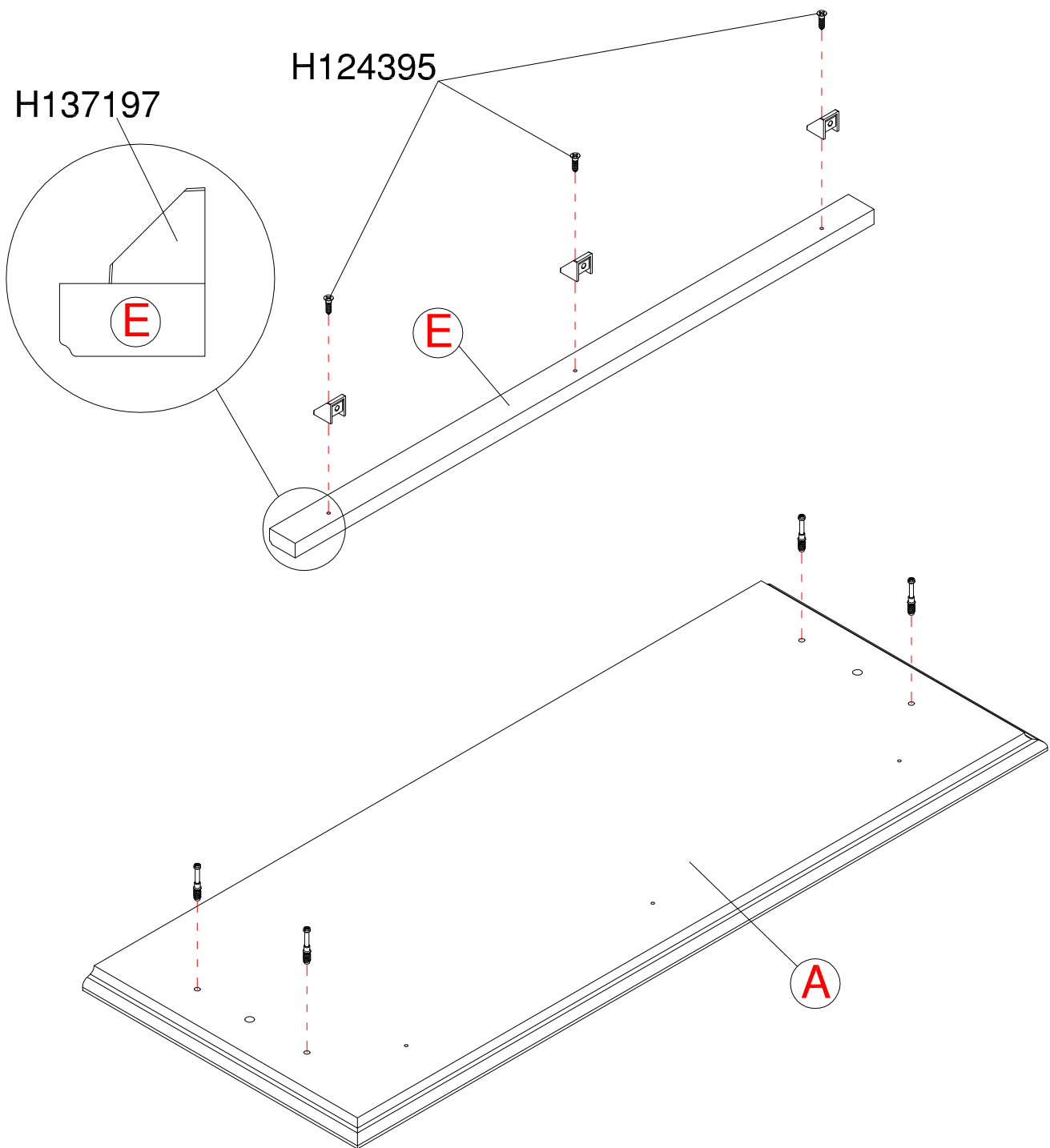

H124395

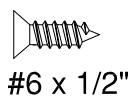

[3]

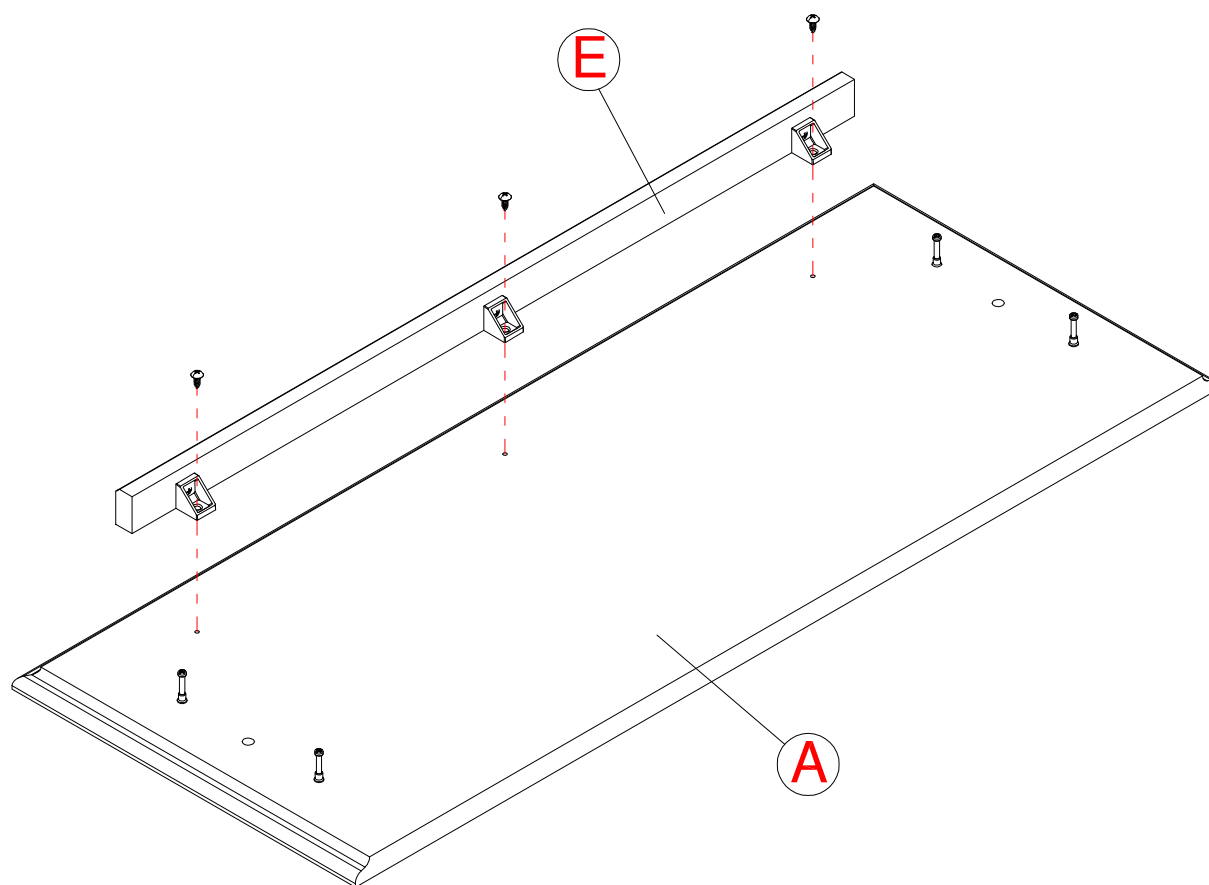

H181468

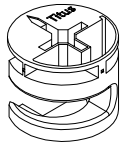

KD Cam

[4]

MODEL KWB132WG

H180730

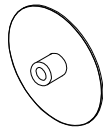

Cover Cap

[4]

MODEL KWB132BC

H159346

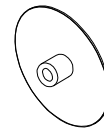

Cover Cap

[4]

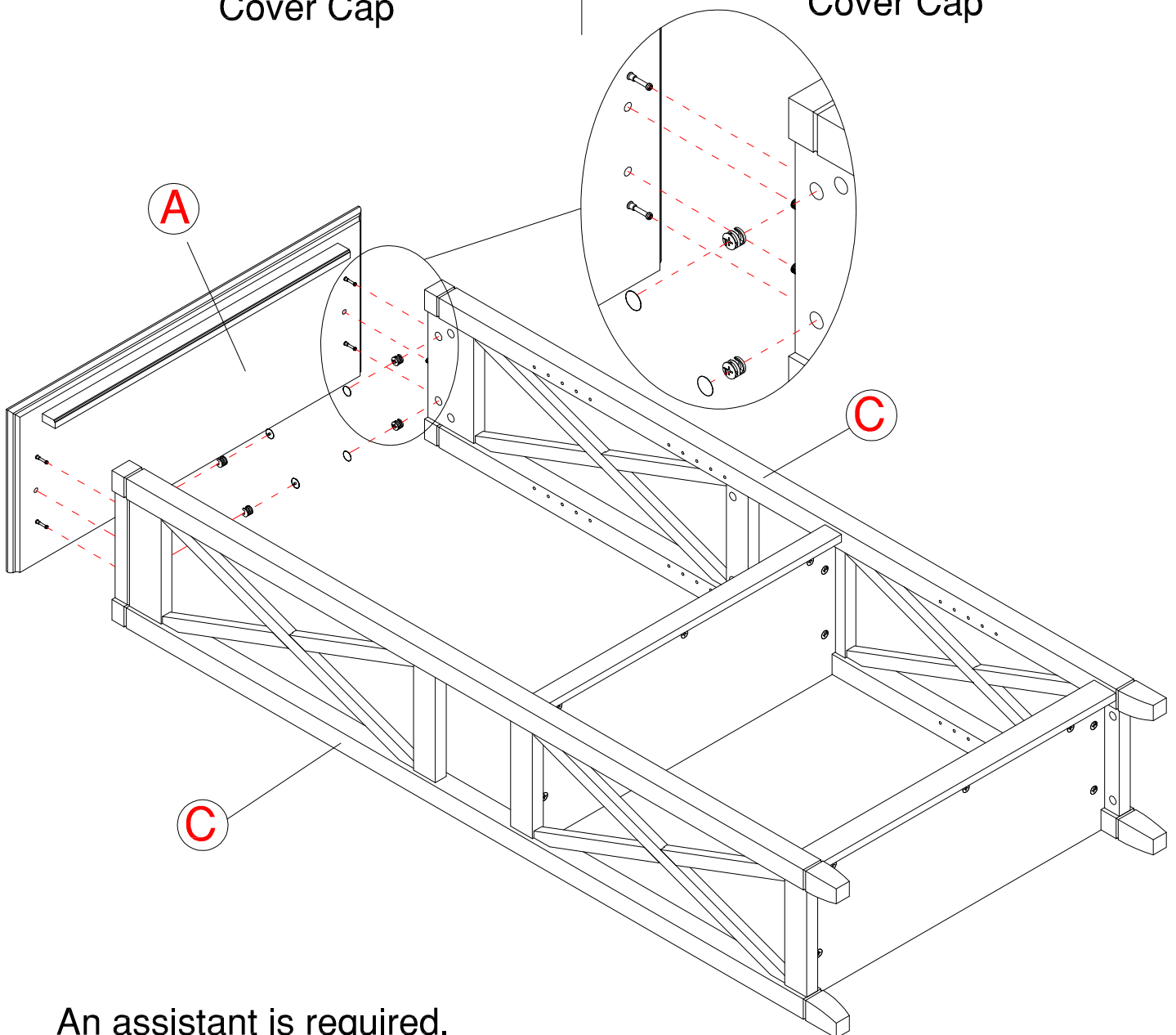

An assistant is required.
Es necesario un ayudante.
Un assistant est nécessaire.

H34174

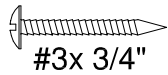

[44]

With assistant carefully flip unit over.

Con un asistente cuidadosamente acueste la unidad.

Avec l'aide d'une autre personne, retourner lentement l'unité sur le rebord frontal.

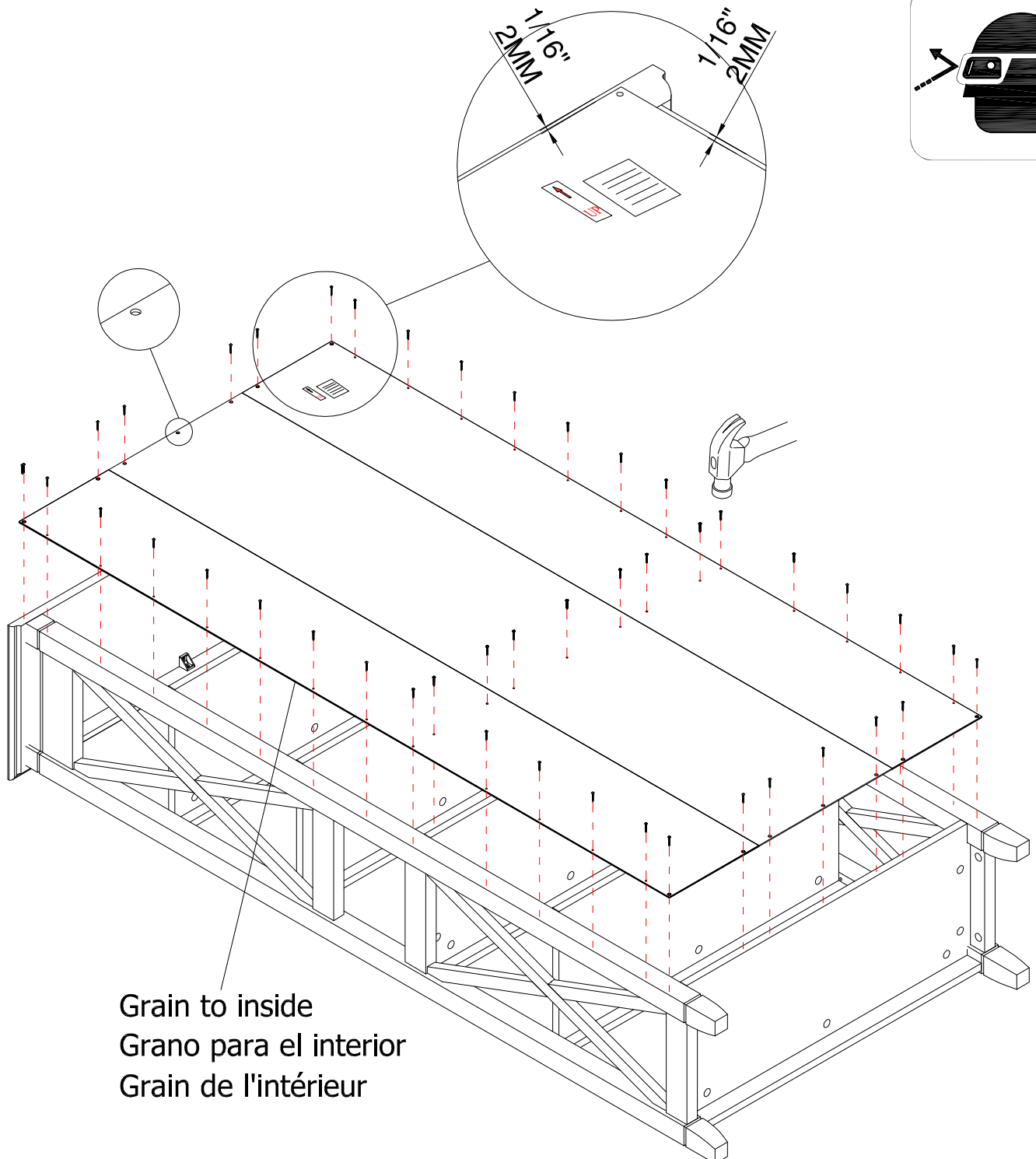

H38169



Wood Dowel
8 x 30mm

[6]

H180604

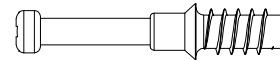

KD Bolt

[9]

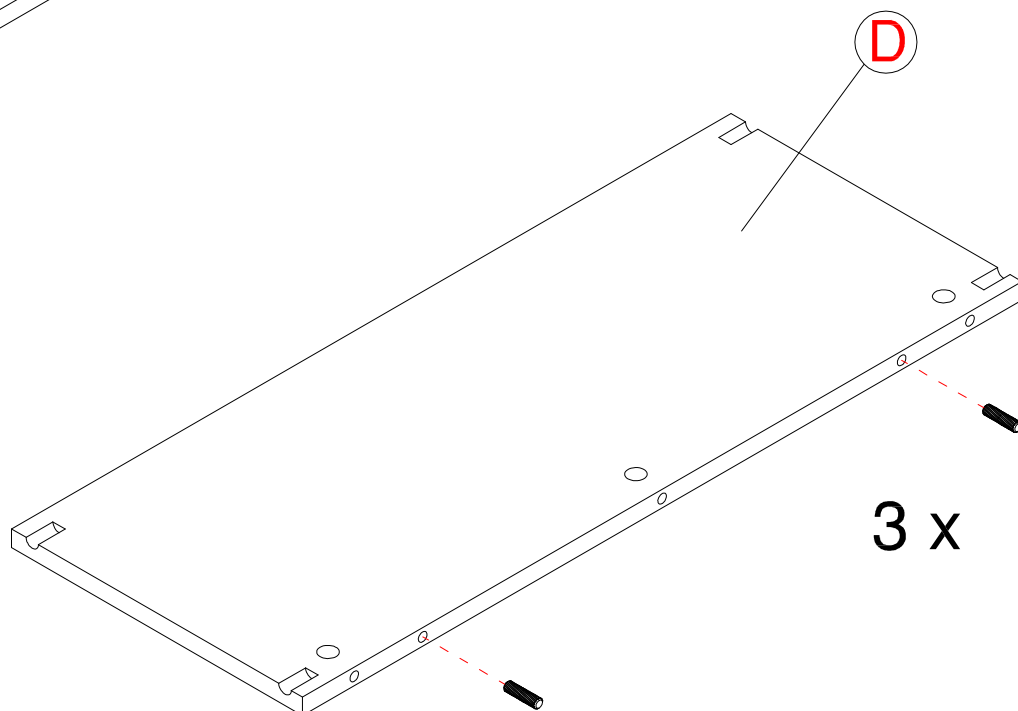
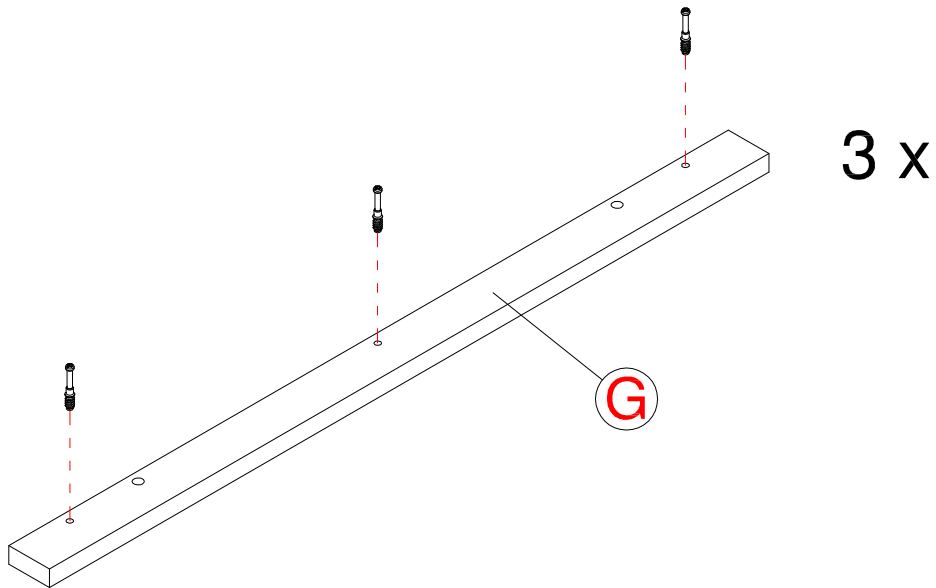

H181468

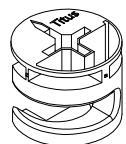

KD Cam

[9]

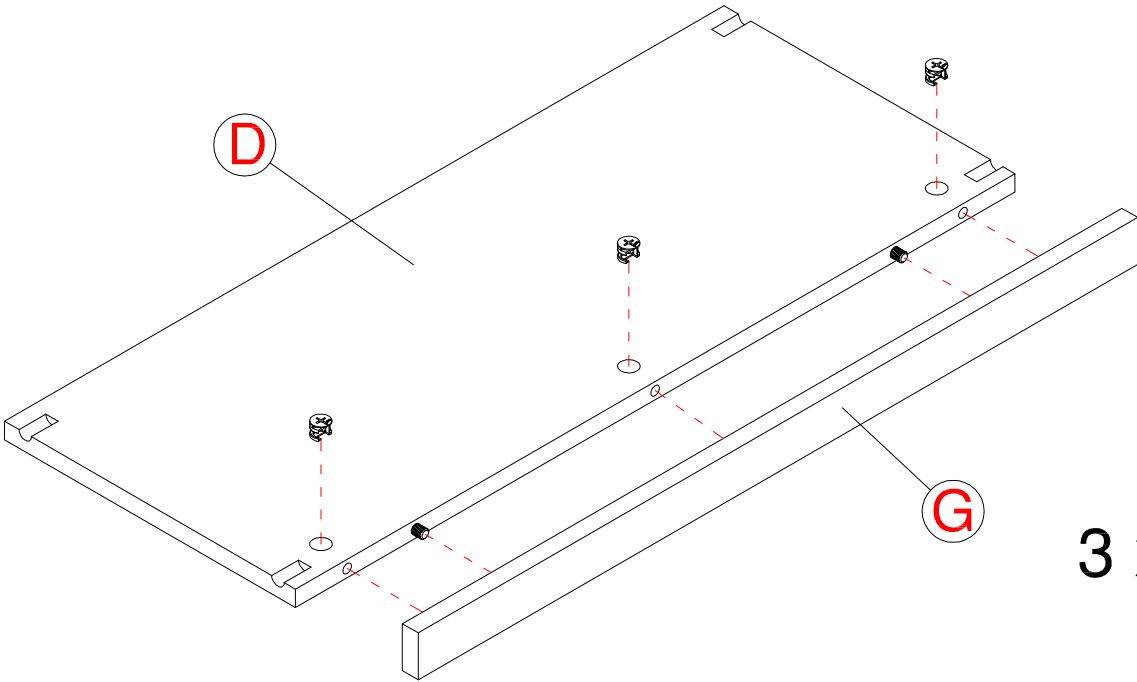

3 x

H23604

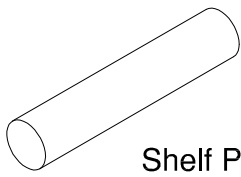

Shelf Pin

[12]

With assistant carefully stand unit up.

Con un asistente cuidadosamente levante la unidad a una posición vertical.

Avec l'aide d'un assistant placez soigneusement l'unité debout.

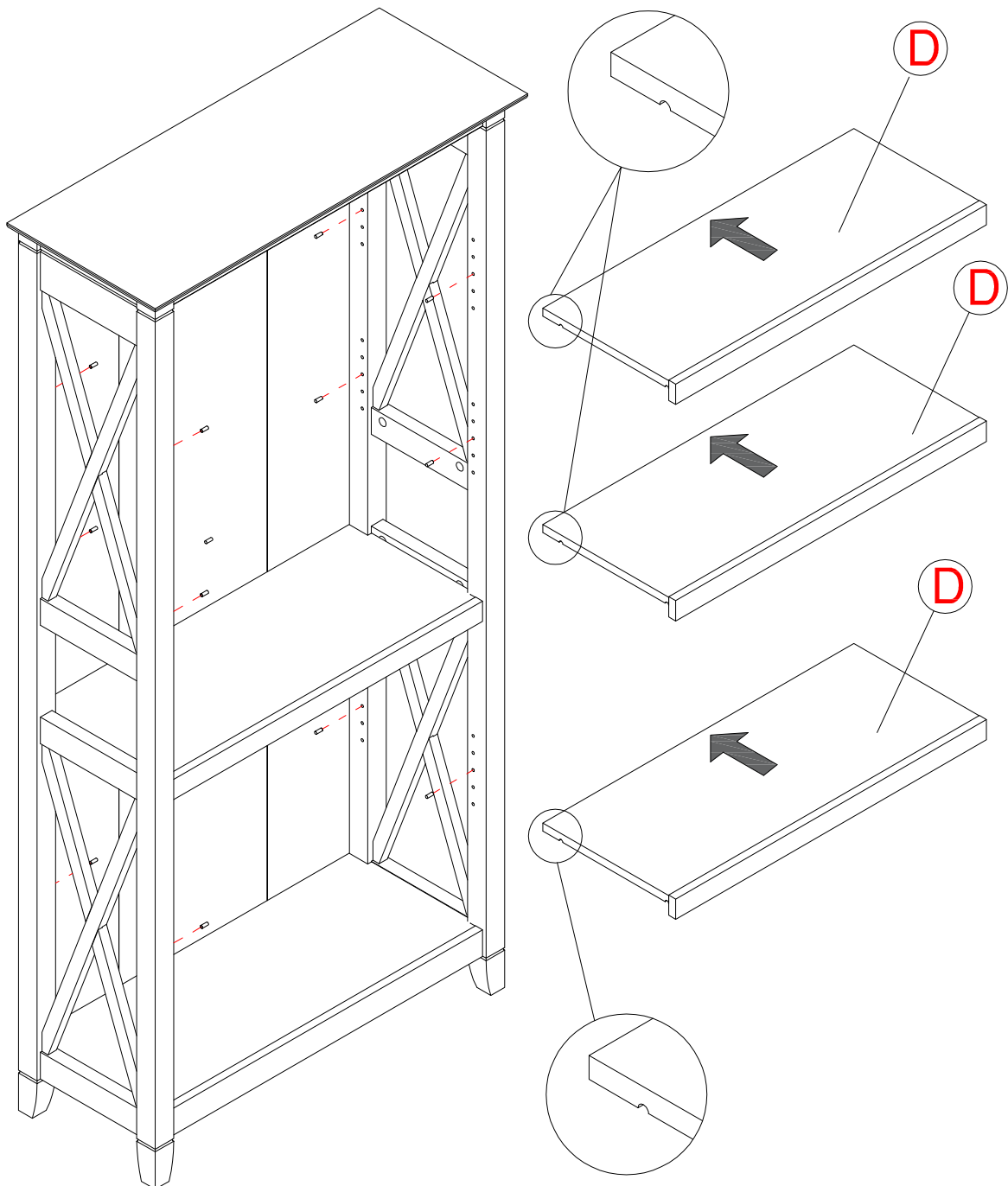

Secure unit to the wall with a tip-over restraint.

Unidad de seguro a la pared con un sistema de retención de un vuelco.

Fixer l'unité au mur avec un dispositif de retenue renversement.

1. Place unit in desired location.
2. Locate wall stud nearest unit center. **FIG A**
3. On wall, mark center of stud location 1" below top of unit. **FIG A**
4. If a wall stud cannot be located mark hollow wall at unit center. **FIG A**
5. On back of unit, mark corresponding location 5/16" below top of unit. **FIG B**

1. Coloque la unidad en el lugar deseado.
2. Localice pie derecho de pared centro de unidad más próxima.
3. En la pared del, marque el centro de la ubicación del montante 1 "abajo la parte superior de la unidad.
4. Si un poste de la pared no se puede localizar marcar pared hueca en el centro de la unidad.
5. En el dorso de la unidad, marque la ubicación 5/16 correspondiente abajo la parte superior de la unidad.

1. Placez l'unité à l'endroit désiré.
2. Localiser centre d'unité la plus proche de la paroi Stud.
3. Sur le mur, centre de emplacement du montant 1 "ci-dessous dessus de l'appareil de la marque.
4. Si un montant de mur ne peut pas être situé marquer mur creux au centre de l'unité.
5. Le dos de l'appareil, marquer l'emplacement 5/16 correspondant ci-dessous dessus de l'appareil.

1" (25mm)

FIG A

Mark wall
Marque la pared
Marquez le mur

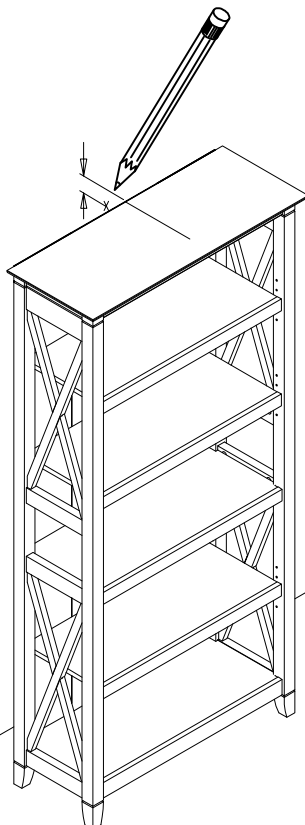
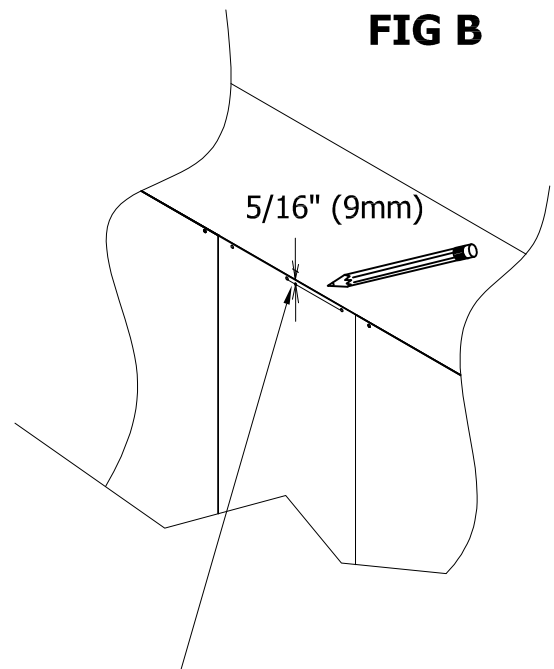
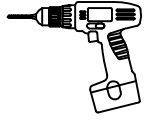

FIG B



Mark back within 6" (150mm) of center.
Marcar de vuelta dentro de 6" (150mm) de centro
Mark dans les 6" (150mm) de centre.

WALL STUD ATTACHMENT



Drill 1/8" hole 2" deep at mark on wall.

Taladro 1/8 "agujero 2" de profundidad en la marca en la pared.

Percer 1/8 "trou de 2" de profondeur à la marque sur le mur.

H181434

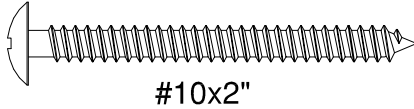

#10x2"

[1]

H181412

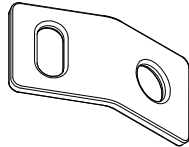

Connecting Plate

[1]

Drywall
Paneles de yeso
cloisons sèches

Wood stud
Montante de madera
Stud bois

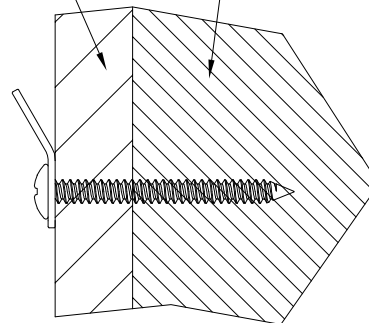
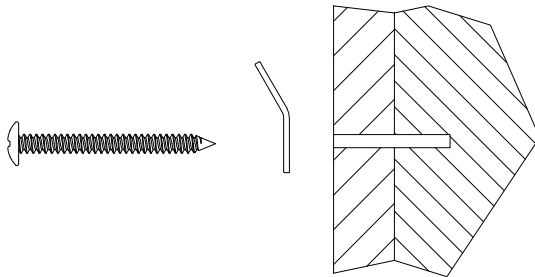

HOLLOW WALL ATTACHMENT

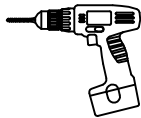

Drill 1/2" hole 1" deep at mark on wall.

Taladro 1/2 "agujero 1" de profundidad en la marca en la pared.

Percer 1/2 "trou de 1" de profondeur à la marque sur le mur.

H181419

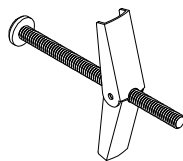

Toggle Bolt

[1]

H181412

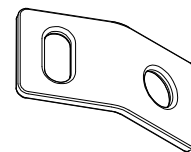

Connecting Plate

[1]

Drywall
Paneles de yeso
cloisons sèches

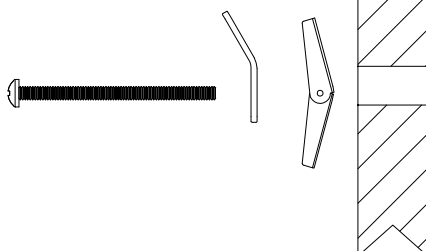

Drywall
Paneles de yeso
cloisons sèches

Pull while tightening
Jale mientras aprieta
Tirer tout en resserrant

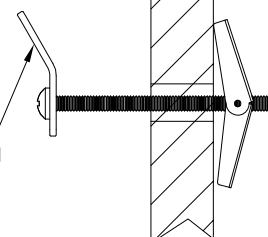

H145191

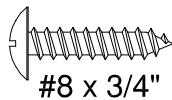

[1]

H181412

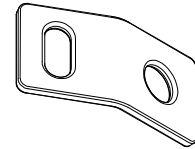

Connecting Plate

[1]

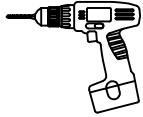

Drill 1/8" hole 1/2" deep at mark on unit.

Taladro 1/8 "agujero de 1/2" de profundidad en la marca de la unidad.

Perçer 1/8 "trou 1/2" de profondeur à la marque sur l'unité.

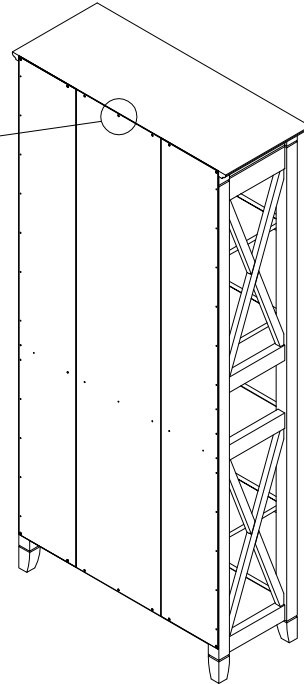
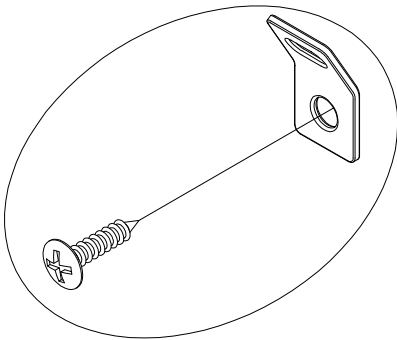

H181411

Nylon Cable Tie

[1]

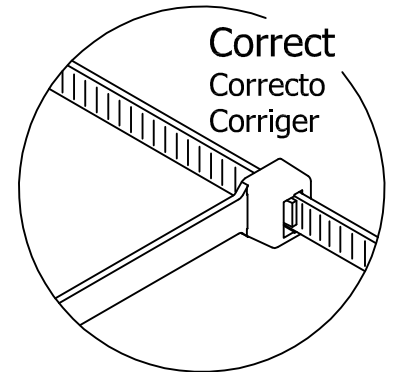
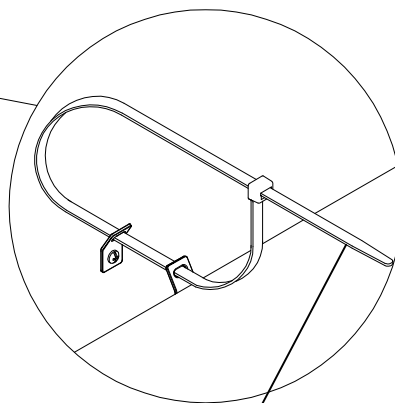
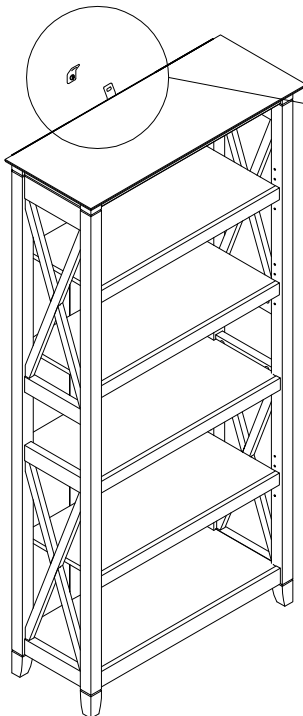
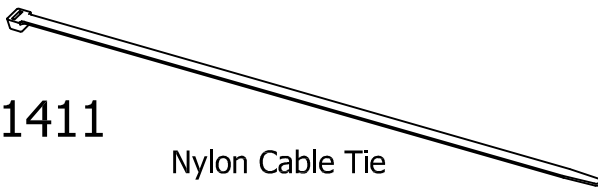

Pull to verify lock

Tire para verificar cerradura

Tirez pour vérifier serrure

Use replacement cable tie with minimum breaking strength of 120lbs.

Utilice reemplazo empate Cable con resistencia a la rotura mínima de 120 libras.

Utilisez remplacement Attache de câble avec une force de rupture minimale de 120 lbs.

THIS PAGE INTENTIONALLY LEFT BLANK

Huali Trading Australia Pty Ltd Limited Three Year Warranty

This limited warranty covers the original purchase of new products used for normal commercial, personal or household use. Huali Trading Australia Pty Ltd (HTA) warrants its products will be free from defects in materials and workmanship (normal wear and tear excepted), for three (3) years from the date of purchase, except as provided below. **Any defective part for this product must be reported to HAT by the purchaser within 30 days of when defect becomes known.** HAT, at its' option, will **repair or replace this product or component(s) free of charge. Original sales receipt will be required prior to repair or replacement.** This warranty applies under conditions of normal use. This warranty does not apply to damage caused by fire, accident, negligence, misuse, use other than as stated in product instructions, improper cleaning or other circumstances not directly attributable to defects in materials and workmanship.

The word defects in this warranty is defined as imperfections that impair the use of the furniture product.

Natural variations occurring in wood or other materials will not be considered defects, and HTA does not warrant the colour – fastness or matching of colours, grains, or textures of such materials. This Warranty does not apply to: modifications of the product, attachments to the product not approved by HTA, and products that were not installed, used, or maintained in accordance with product instructions and warnings.

This warranty has the following exceptions: Fabrics, foam, veneer finishes and other covering materials are warranted for two (2) years from date of purchase.

Proof of purchase is required in the form of a receipt (copy or original) to validate warranty. All warranty claims can either be sent to:

sales@hualitrading.com.au

Or faxed to (02) 9621 1050

HTA's sole obligation and the users exclusive remedy under this warranty shall be limited to the repair, Credit (only applies to distributors) or replacement at HTA's sole discretion and cost, of product or components under the "COMPETITION AND CONSUMER ACT 2010".

"Our goods come with guarantees that cannot be excluded under the Australian Consumer Law. You are entitled to a replacement or refund for a major failure and for compensation for any other reasonably foreseeable loss or damage. You are also entitled to have the goods repaired or replaced if the goods fail to be of acceptable quality and the failure does not amount to a major failure".

Service Instructions

If you are having trouble with assembling your new furniture, please call us on (02) 9621 4701 for assistance.