

LEGION

LEGION GAMING CHAIR C7

Model# 52014-GRY/BLK

52015-GRY/WHT



Attention:

1. Do not stand on the seat cushion.
2. For indoor use only. Please do not expose to direct sunlight, sources of excessive heat, or use in wet or damp environments.
3. Do not allow children to play on or near this product.
4. Please avoid use of sharp objects on or near this product.
5. Clean spills / marks immediately, as stains are harder to remove when they are left unattended.
6. Only a damp cloth should be used to clean the upholstery surface. For persistent stains and overall cleaning, contact a professional upholstery cleaning company.
7. Do not use power tools. Only use the Allen Key provided. Check and re-tighten screws and knobs every 90 days.
8. The casters sold with this chair are intended for use on carpet and not recommended for use on tile or hard wood floors. Using these casters on tile or wood flooring may cause floor surface damage, so please consider purchasing a chairmat to protect your floor surfaces.

PARTS LIST

A



Casters X5

B



Base X1

C



Gas Lift X1

DL



Left Arm X1

DR



Right Arm X1

E



Back Cushion X1

F



Seat Cushion X1

G



Headrest X1

H



25mm Big Screws
(Hex Head) X3

I



25mm Big Screws
X2

J



38mm Big Screws
X2

K



16mm Small
Screws X1

L



Allen Key X1



Note: Do not use power tools. Only use the Allen Key provided.

ASSEMBLY

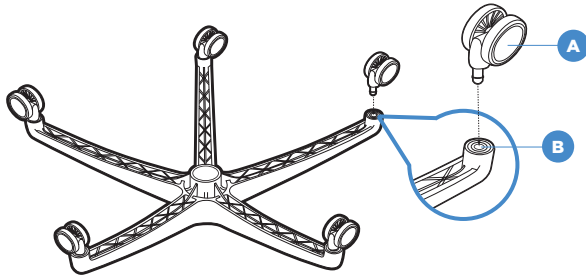

Step 1

Place the Base (B) upside down and insert 5 Casters (A) into the holes on the Base (B).

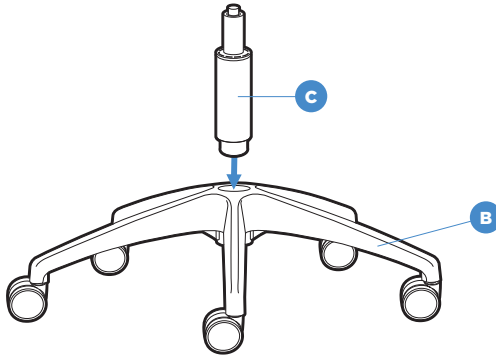

Step 2

Turn the Base (B) over and insert the Gas Lift (C) through the center hole on top of Base (B).

Step 3

Insert Back Cushion (E) into the rear hole of the seat plate as shown. Then secure with 25mm Big Screws (H). Note: Tighten the screws completely.

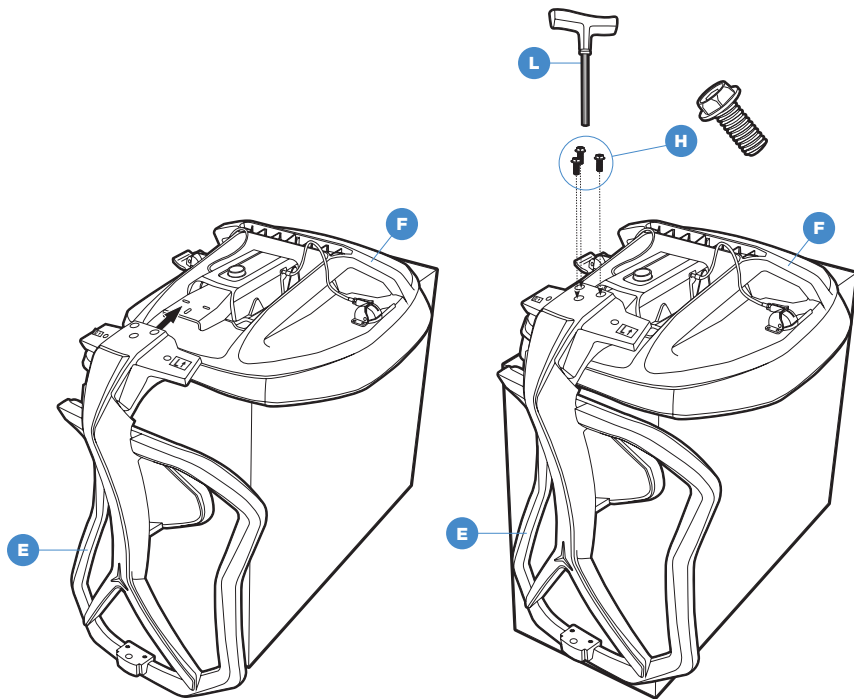

Step 4

Insert Arms (DL & DR) into the bottom of Back Cushion (E) as shown. Then secure with 38mm Big Screws (J) as shown.

Note: Assemble screw J first, then screw I. Tighten the screws completely.

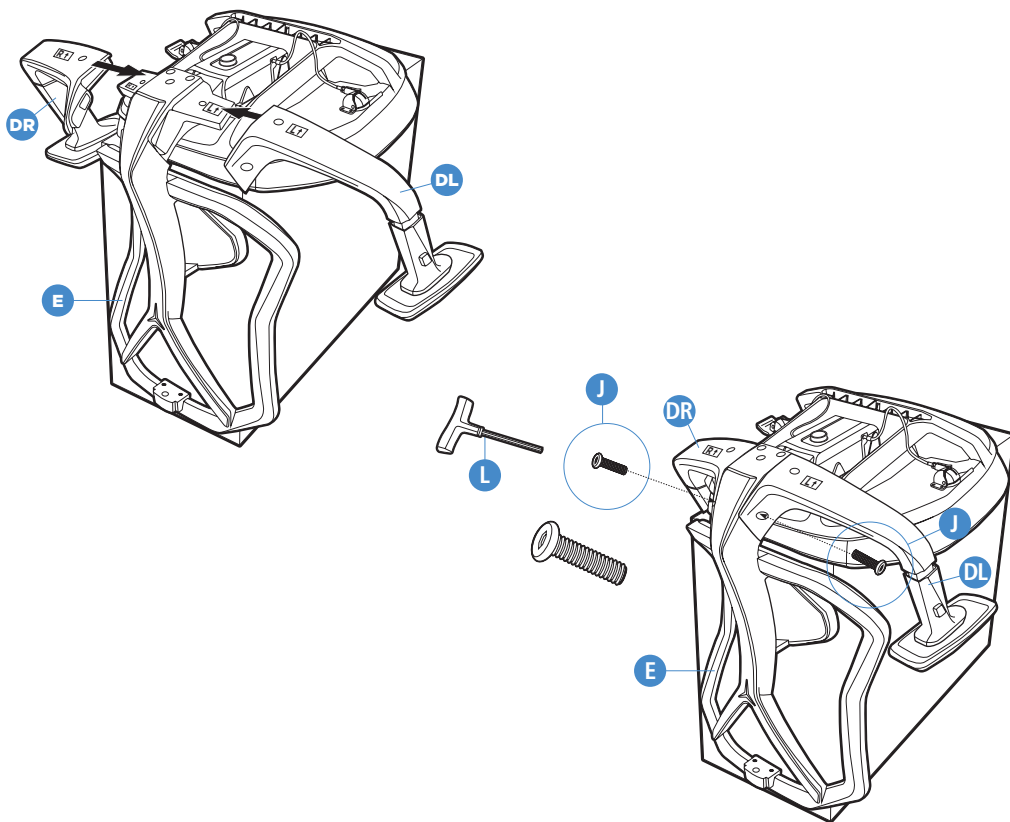

Step 5

Insert 25mm Big Screws (I) to the bottom of the arms as shown. Tighten the screws completely.

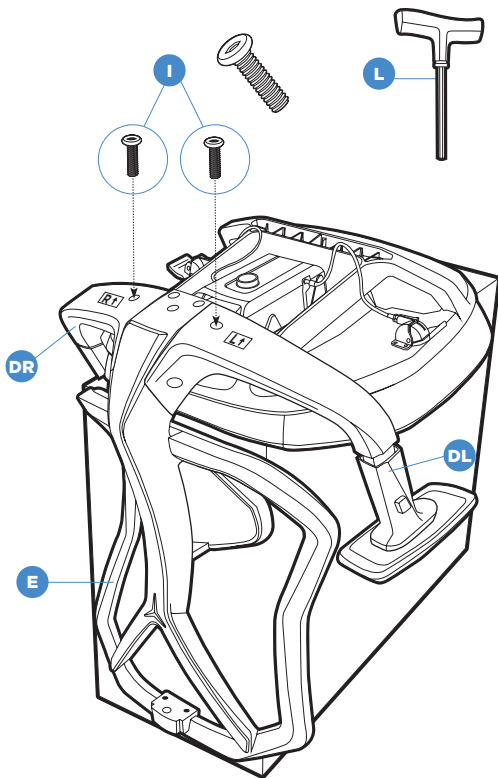

Step 6

Position the assembled chair upright with the seat plate facing down. Insert the Gas Lift (C) into the center hole of the seat plate. Push down firmly over the Gas Lift (C) until it is securely connected.



Step 7

Attach the Headrest (G) to the Back Cushion (E) by using 16mm Small Screws (K) as shown. Note: Tighten the screws completely.

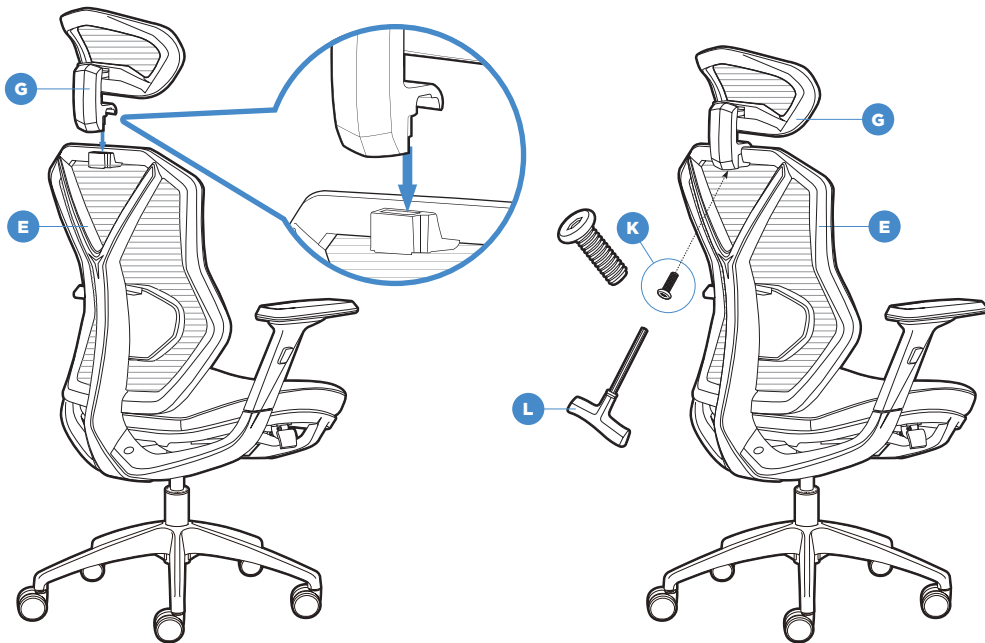

Function Instruction 1

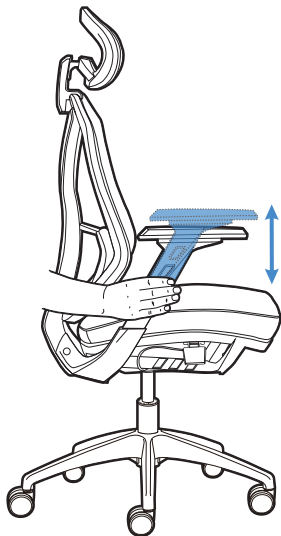

To Adjust Arm Height:

Press the buttons to allow the arms to move up or down freely then release the buttons once the desired height is reached.

Function Instruction 2

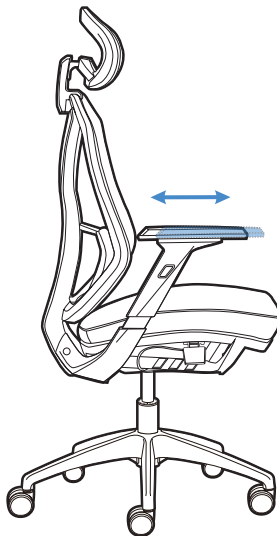

To Adjust Armrests Forward & Backward:

While seated, grasp the armrests and push them forward or backward to desired position.

Function Instruction 3

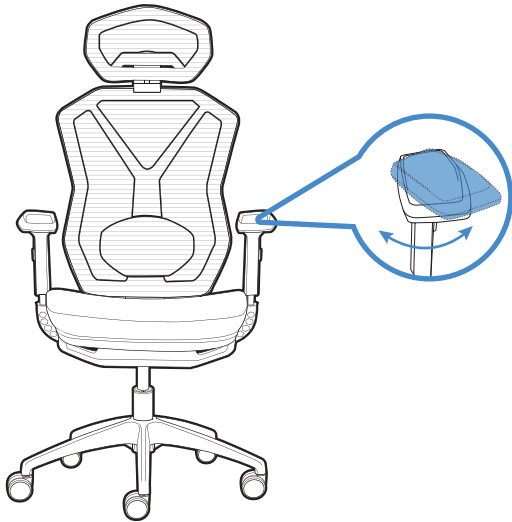

To Adjust Armrests Angle:

While seated, grasp front end of armrests and pivot them to the left or right. Adjusting arm angle can help support different types of work and shifts in posture.

Function Instruction 4

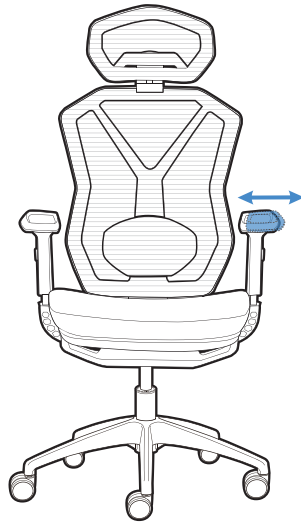

To Adjust Armrests Width:

While seated, hold and push the armrests outwards or inwards into a desired width of arms.

Function Instruction 5



To Adjust Headrest Height:
Headrest height adjust independently for the short and tall.

Function Instruction 6

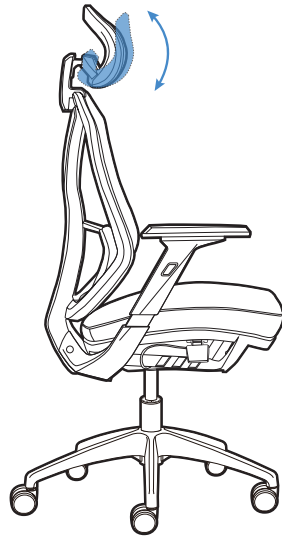

To Adjust Headrest Radian:
Swivel up and down for optimum neck comfort.

Function Instruction 7

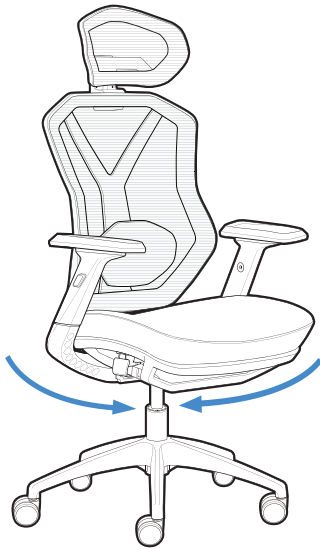

360° Swivel:

Allows the seat to swivel 360 degrees.

Function Instruction 8

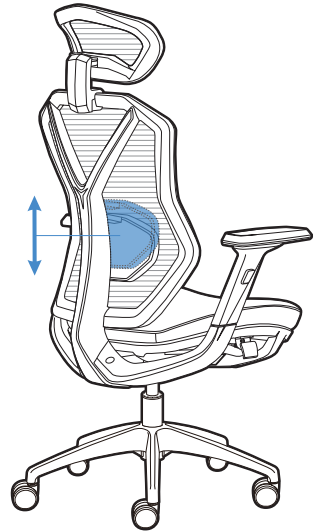

To Adjust Lumbar Support Height:

Lumbar support height adjust independently for the short and tall.

Function Instruction 9

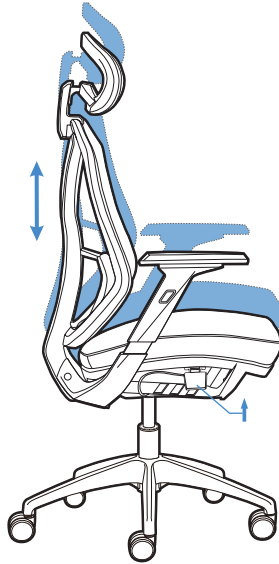

To Adjust Seat Height:

While seated, lean forward and reach under the right side of the chair to find the lever. Lift the lever and raise your body up slightly to allow the chair to rise to the desired height. Once desired height is reached, release lever to lock chair at desired height. To lower the seat, lift the lever while seated. The chair will descend until the lever is released or the chair reaches the bottom position.

Function Instruction 10

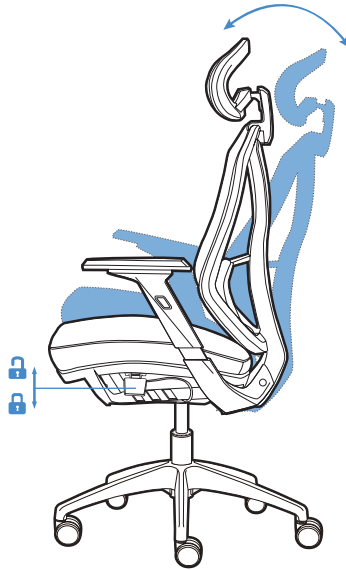

To Operate Tilt Lockout:

While seated, reach under the left side of the chair to find the lever. Pull up the lever and lean back to allow the chair to tilt backwards. Push the lever to the down position to lock the chair angle while the desired position is reached. Once you want to release the mechanism from the lock position, pull the lever upward (If pull the lever upward, apply more weight backward onto the back rest cushion and then release, the back rest cushion will come back to normal position.) Note: The force of the backrest can adjust automatically to the individual weight.

Limited Warranty

Huali Trading seating products are warranted against defects in material and workmanship while owned by the “Original Purchaser”. The term “Original Purchaser” is defined as that party or entity which purchases Huali Trading furniture from an authorized Huali Trading retailer as shown by the original sales receipt. This warranty does not apply to “as is” or previously owned seating products.

Huali Trading warrants its products to be free from defects in materials and workmanship (normal wear and tear, fading and stretching excepted), for THREE year from the date of purchase, except as provided below under the limited warranty.

The exceptions or exclusions to this warranty are as follows:

1. Upholstery material and foam cushion material is warranted against defects in material and workmanship for a period of 1 year, beginning on the date of purchase as shown on the original sales receipt.
2. Any warranty claim that is submitted after the limited warranty period, or without proper proof of purchase will not include the cost of parts, labour, or delivery.
3. This warranty shall not apply to Huali Trading products which have been subjected to misuse, neglect, alteration, modification or attachments, either caused by the original purchase, shipping, storage, accident, fire, flood or acts of God.

In the event of a defect in material or workmanship covered by this warranty, Huali Trading will repair or replace, at their discretion, without charge the warranted furniture within a reasonable amount of time. We reserve the right to require damaged parts to be returned to us upon request. Natural markings such as scars, brands, grain variations, wrinkles, colour variations, etc. will be considered normal characteristics and not construed as defects. We cannot warrant upholstery against scratching or scuffing, as all upholstery is subject to blemishes with use.

For claims or questions converting this warranty, please contact Huali Trading Customer Service department through email on services@hualitrading.com.au or the retailer the seating product was purchased from.

Huali Trading's sole obligation and the users exclusive remedy under this warranty shall be limited to the repair, credit (only applies to distributors) or replacement at Huali Trading's sole discretion and cost, of product or components under the “**COMPETITION AND CONSUMER ACT 2010**”.

Our goods come with guarantees that cannot be excluded under the Australian Consumer Law. You are entitled to a replacement or refund for a major failure and for compensation for any other reasonably foreseeable loss or damage. You are also entitled to have the goods repaired or replaced if the goods fail to be of acceptable quality and the failure does not amount to a major failure”.

All warranties are limited to the original purchaser for normal use which is defined as a standard work week of forty hours by a person weighing less than 125kg.

We are here to help if you have any questions, comments, or are in need of warranty replacement parts. Call us toll free at: (02) 9621 1131